



90-163

90 SERIES 3 POLE MECHANICAL CONTACTORS

Designed for air conditioning and heating equipment.

FEATURES

- Any position mounting
- Interchangeable mounting plate
- Low wattage coil
- Double break contacts ensure positive make and break

SPECIFICATIONS

Approximate Overall Dimensions 3.00"H X 2.38"W X 3.75"D
 Temperature Range..... -40°F to 150°F
 Mechanical / Electrical Life..... Conforms to UL and ARI specifications
 Coil Voltage / Frequency / Insulation.....24, 120, 208, 240 VAC / 50-60 Hz / Class B (130°C)
 Termination.....Screw terminals or lugs and double 1/4" Q.C.
 Operate.....85% - 110% of nominal coil voltage
 Duty Cycle..... Continuous
 Weight (approximate) 16 oz.
 UR/CUR File Number E310181
 CE Approved

90 SERIES 3 POLE MECHANICAL CONTACTORS - COIL DATA

VOLTAGE AC	MODEL	RES DC OHMS	CURRENT MA	NOMINAL VA	MAX. INRUSH VA	MODEL NUMBER	ITEM NUMBER
24	30 AMP	7.0	208	5.0	60	90-163	90 163S1
24	40 AMP	7.0	208	5.0	60	90-170	90 170S1
120	30 AMP	175	42	5.0	60	90-164	90 164S1
120	40 AMP	175	42	5.0	60	90-171	90 171S1
208 / 240	30 AMP	665	21	5.0	60	90-165	90 165S1
208 / 240	40 AMP	665	21	5.0	60	90-172	90 172S1

90 SERIES 2 POLE MECHANICAL CONTACTORS - CONTACT RATINGS

VOLTAGE AC	FLA	LRA	RES	TYPE
240 / 277	30	180	40	90-163 thru 90-165
480	30	150	40	90-163 thru 90-165
600	30	120	40	90-163 thru 90-165
240 / 277	40	240	50	90-170 thru 90-172
480	40	200	50	90-170 thru 90-172
600	40	160	50	90-170 thru 90-172

40 AMP WITH LUGS

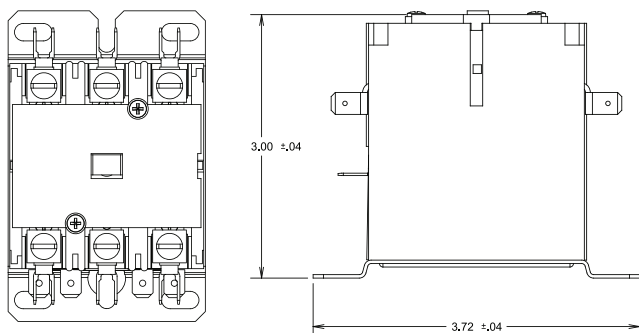

30 AMP WITH SCREW TERMINALS

